

C. BERNARD SHEA ROWING CENTER
 Princeton University

Architectural Resources Cambridge, Jeff Peterson, Project Architect
 Program: 20,000 s.f. renovation, 15,000 s.f. addition featuring 7 boat bays, 1 repair bay, 16-person rowing tank, training rooms, weight room, lockers and showers, coaches apartment, Sikes Room, offices, Club Room
 Cost: \$6 million
 Completion: Dedicated October 2000
 Photography: Nick Wheeler



One of the primary factors in the design of the C. Bernard Shea Rowing Center was the view of the facility from the Washington Road Bridge. As a gateway to Princeton University, the original Class of 1887 Boathouse offered a picturesque view with its tower, porch and launch house. The redesigned facility, including the new Richard Ottesen Prentke Training Center, retains the architectural coherence of the original structures.

To achieve that coherence, the addition replicates the bay spacing of the original building, while the clusters of tall windows echo the triple windows of the original building. The addition also features modernized versions of the old boathouse's buttresses. The dramatic arch of the rowing tank recalls the arches of the Washington Street Bridge.

The tower is the facility's entry and focal point. On the second floor, it houses a lofty sky-lit space, featuring mahogany flooring and wainscoting, and glass donor-recognition panels. A gallery, overlooking the lake and featuring historical photographs of crews past, extends to the west. A corridor off the gallery leads to shower and locker facilities. The gallery arrives at the renewed Club Room with lounge seating, trophy cases, and video facilities.

The addition, the Prentke Training Center, contains generous workout spaces framed with exposed timber trusses reminiscent of those in the Club Room. Crisp mahogany trim and wainscoting protect the walls. Toilets and showers in the Prentke Center allow the workout rooms to function as visiting team changing rooms. The ground floor includes two new boat bays, and the new moving-water rowing tank. In the tank, the large arched windows recall the arches of the Washington Street Bridge; they frame the 16 rowers, creating a symbolic connection between rowers, lake and bridge.

The new Richard Ottesen Prentke Training Center is modern yet resides comfortably with the old Boathouse. The resulting C. Bernard Shea Rowing Center is a bright and refreshing facility that not only unifies the old and new structures, but also restores the picturesque view from the bridge that welcomes visitors, faculty, students and alumni to the Princeton Campus.



C. BERNARD SHEA ROWING CENTER
 Princeton University

Architectural Resources Cambridge

First Floor Plan

- 1. Entry
- 2. Stair
- 3. Hall
- 4. Mechanical
- 5. Repair Bay
- 6. Boat Bay Tank Room

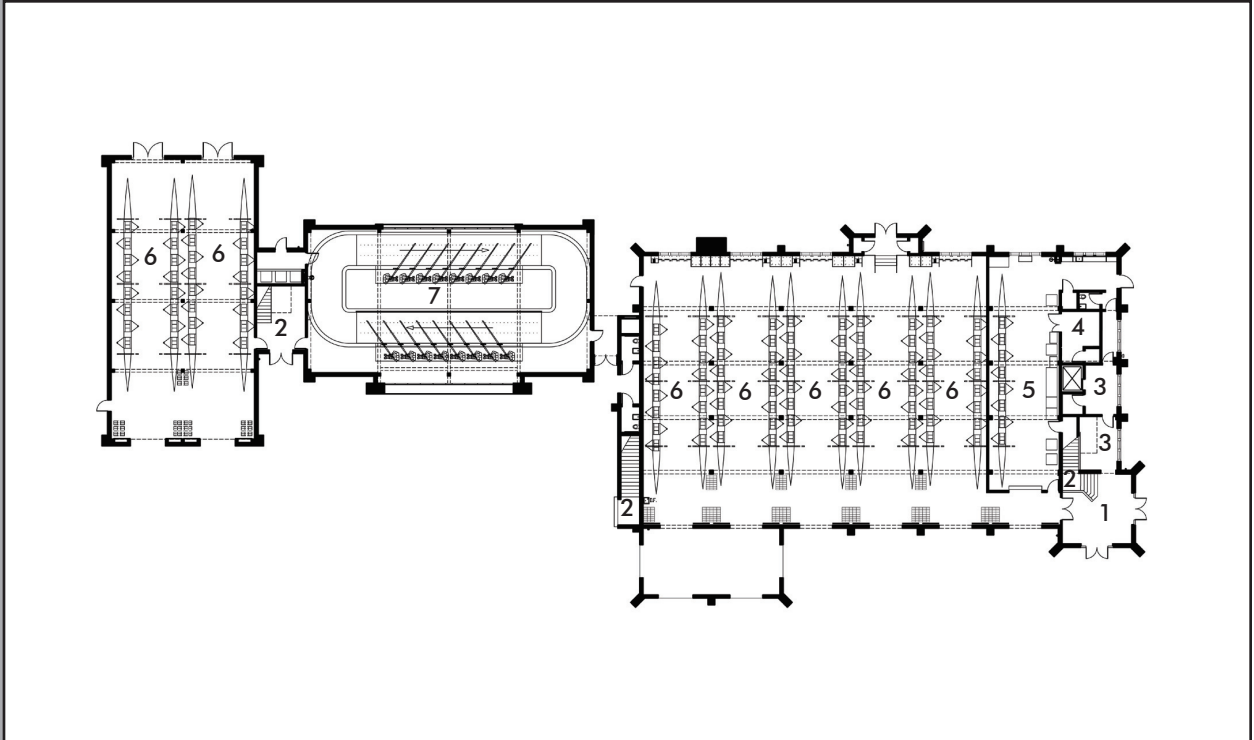

Second Floor Plan

- 1. Landing
- 2. Stair
- 3. Living Room
- 4. Bedroom
- 5. Lockers
- 6. Showers
- 7. Toilet
- 8. Gallery
- 9. Club Room
- 10. Sikes Room
- 11. Workout
- 12. Weights
- 13. Office

